

4130 CAHUENGA

4130 CAHUENGA BLVD. TOLUCA LAKE, CA 91602

■ SUITE 206*
3,617 RSF

■ SUITE 210*
6,800 RSF

■ SUITE 230
2,215 RSF

*Contiguous to 10,417 RSF

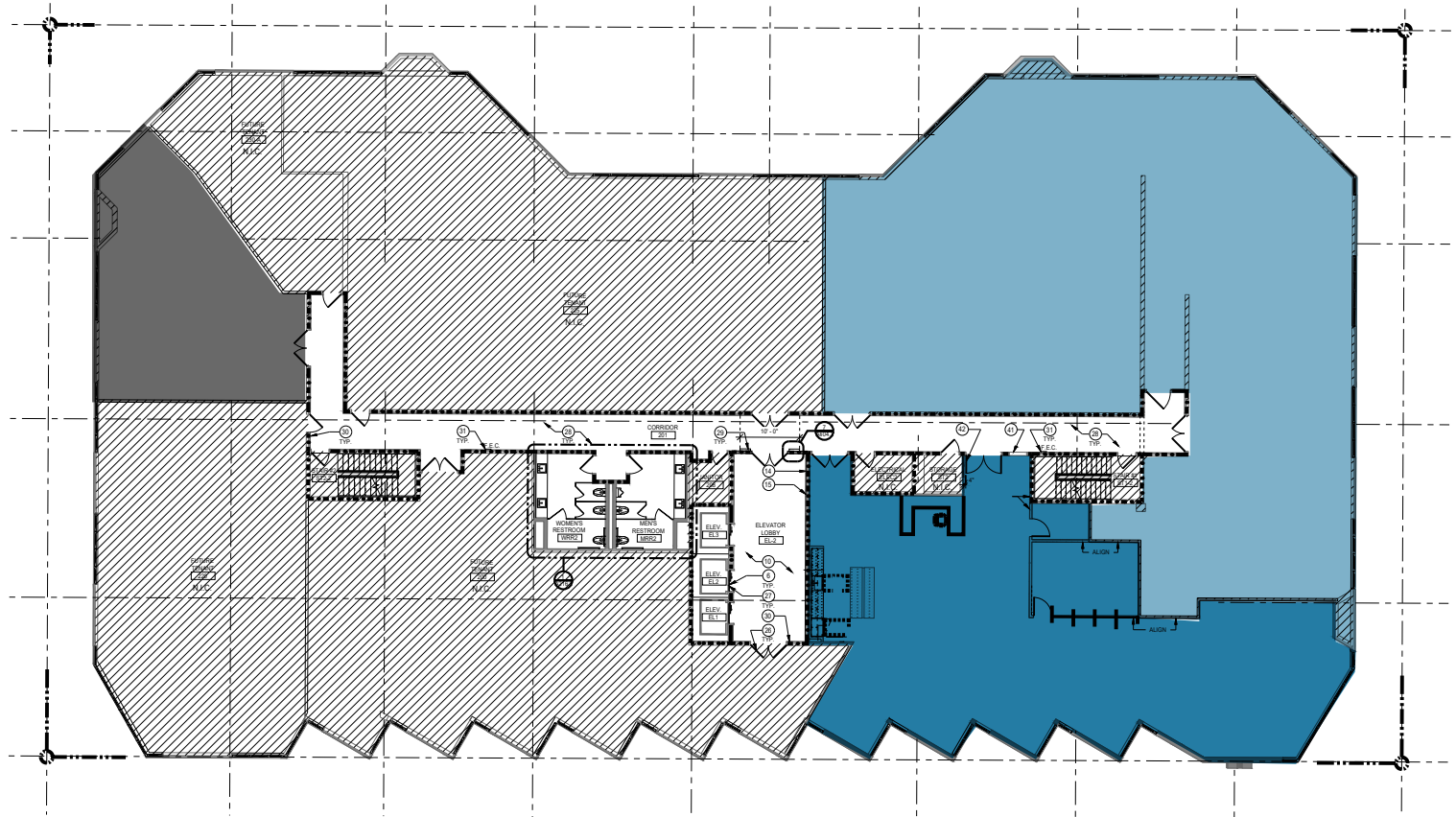

CLICK FOR
VIRTUAL TOUR
OF SUITE 206

DOUG MARLOW
Executive Vice President
Lic. 00409987
+1 818 502 6707
doug.marlow@cbre.com

JULIANA SAMPSON
Senior Associate
Lic. 01894878
+1 818 502 6772
juliana.sampson@cbre.com

© 2021 CBRE, Inc. All rights reserved. This information has been obtained from sources believed reliable, but has not been verified for accuracy or completeness. You should conduct a careful, independent investigation of the property and verify all information. Any reliance on this information is solely at your own risk. CBRE and the CBRE logo are service marks of CBRE, Inc. All other marks displayed on this document are the property of their respective owners, and the use of such logos does not imply any affiliation with or endorsement of CBRE.

CBRE

HARBOR
ASSOCIATES